

RAPTOR 1:8 GT ELO

Instruction Manual Add-in





SETUP

The default setup proposed in this instruction manual can be considered a pretty good starting point for assembling your RAPTOR GT, but a further fine tuning according to your driving style, type of track and environmental conditions will be a key aspect for preparing a high performance race model.

INSTRUCTIONS

The exploded views will drive you step by step through the different assembling phases and show all the parts you need.

SAFETY

This is a highly technical hobby product intended to be used in a safe racing environment.

Only operate this car in a safe environment, like a special racing track or a closed parking lot. Avoid using this car on public roads, crowded places or near infants.

Before operating this car, always check the mechanical status of the car. Check that the batteries of the transmitter and receiver are fully charged.

Avoid using this car in wet conditions as the water will cause corrosion on the metal parts and bearings and these parts will cease to function properly. If driven in the wet, ensure that all the electric equipment is waterproofed and after use, that all moving parts are dried immediately.

GT20228

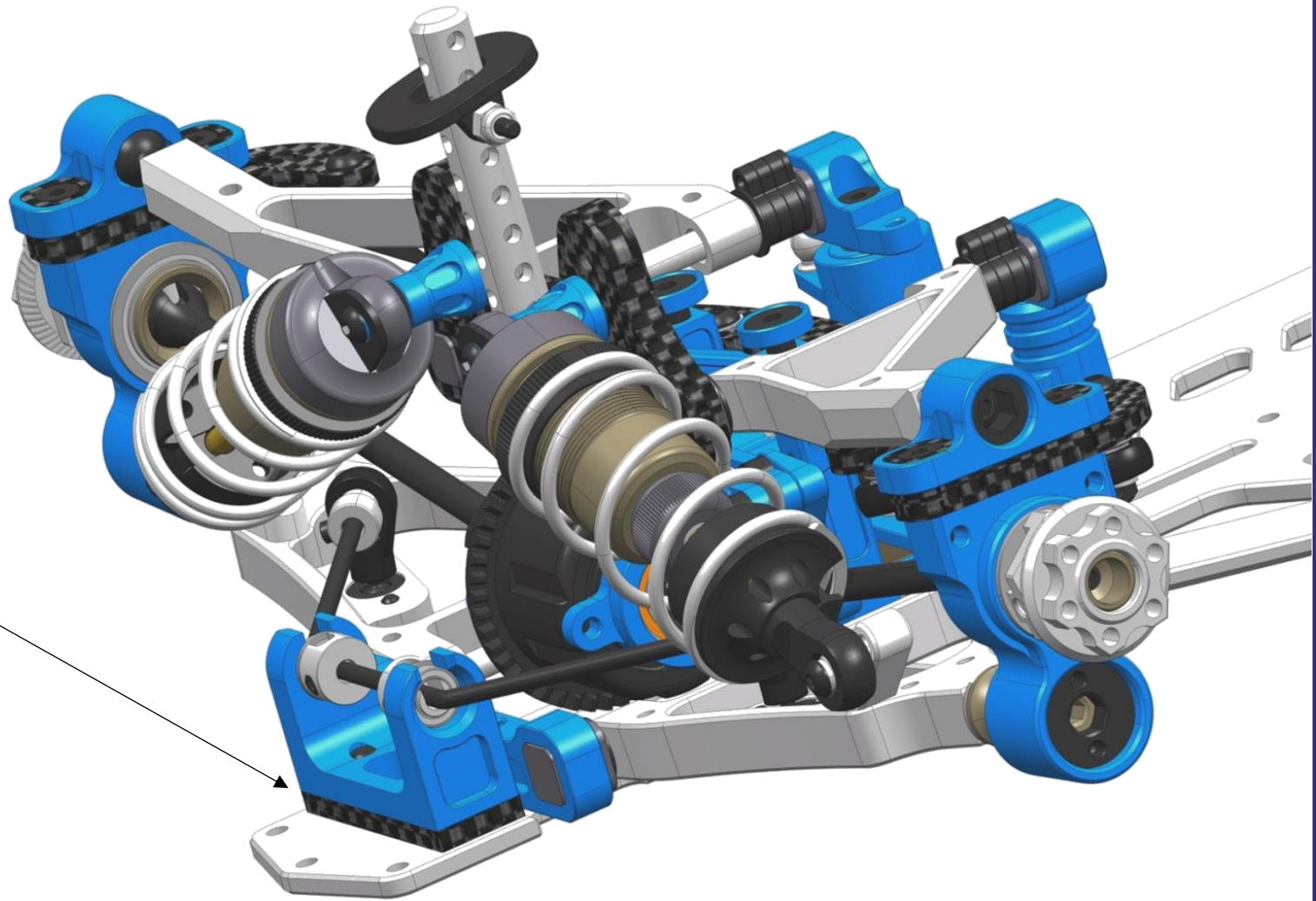

Rear Battery Holders

Exploded View - Step 0

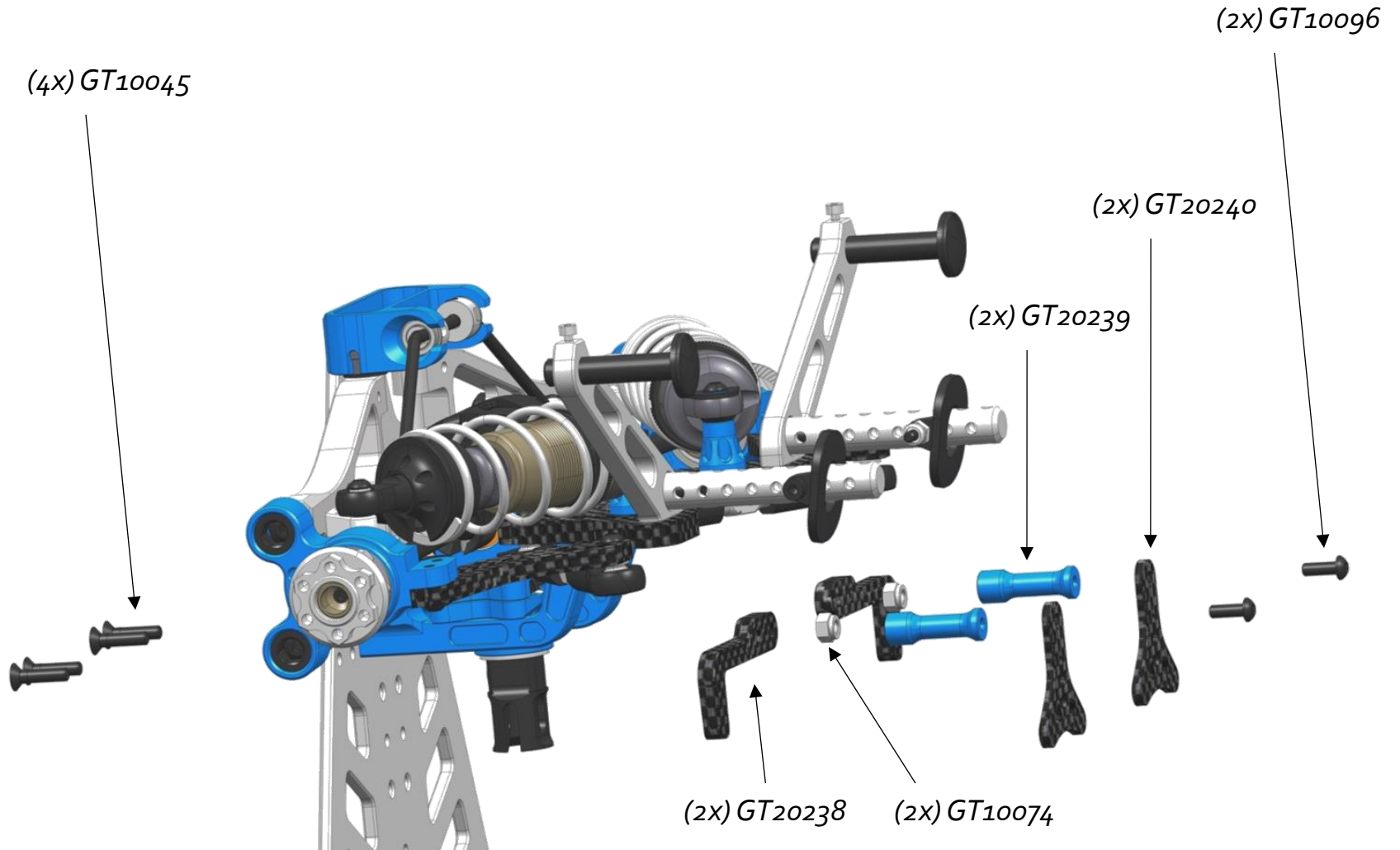

Central Battery Holders

Exploded View - Step 1

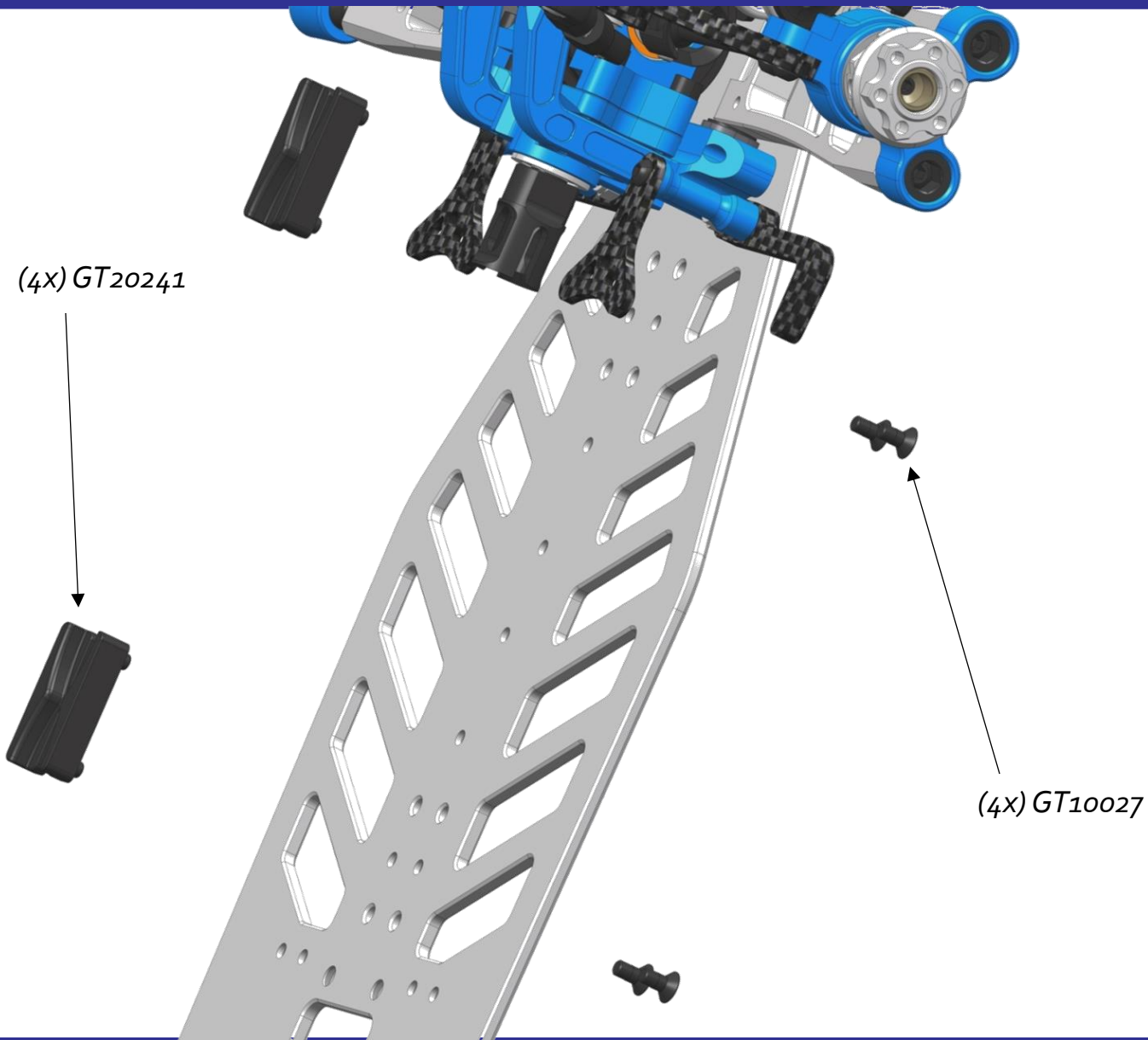

Front Battery Holders

Exploded View - Step 2

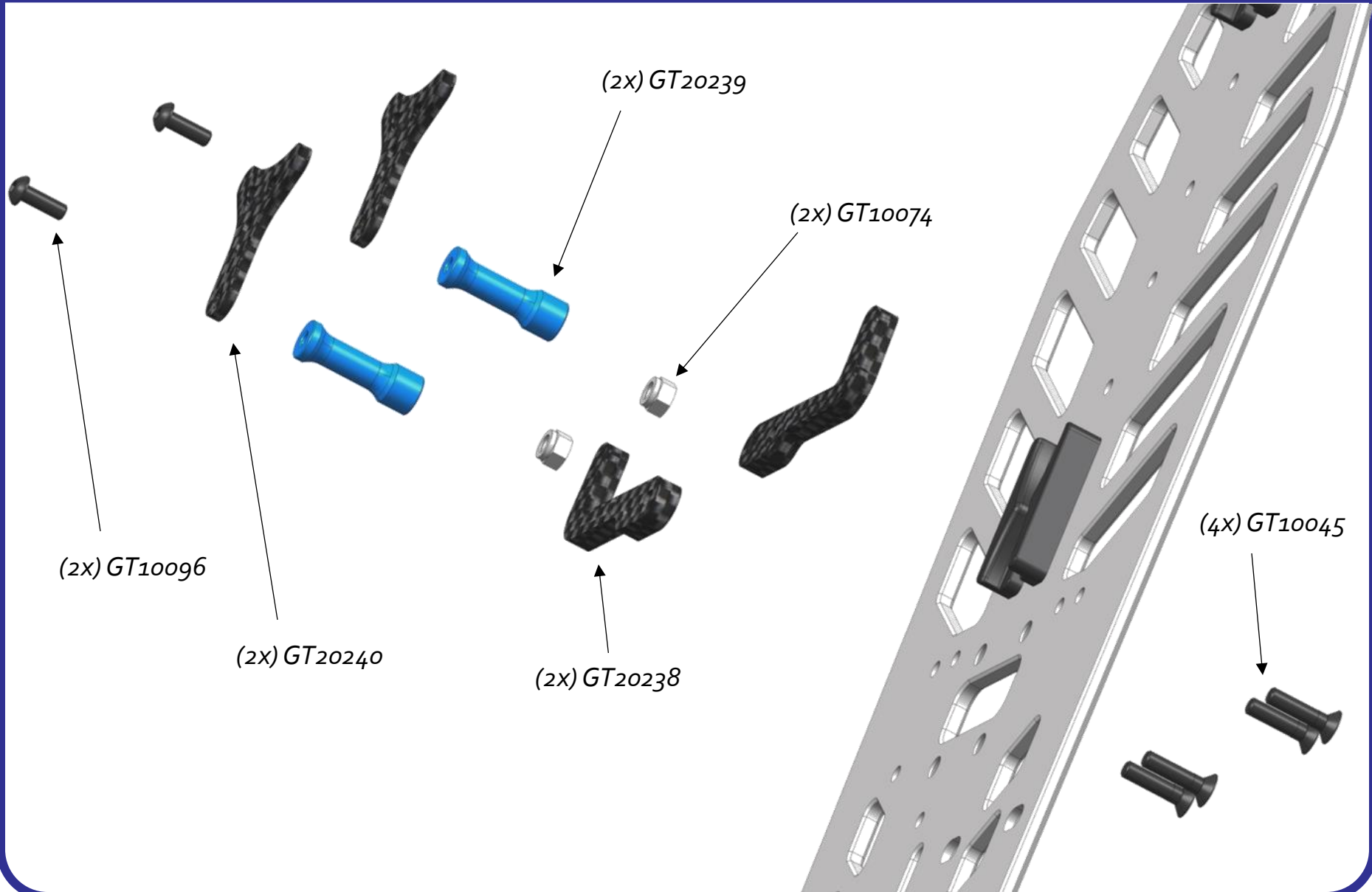

Motor Assembly

Exploded View

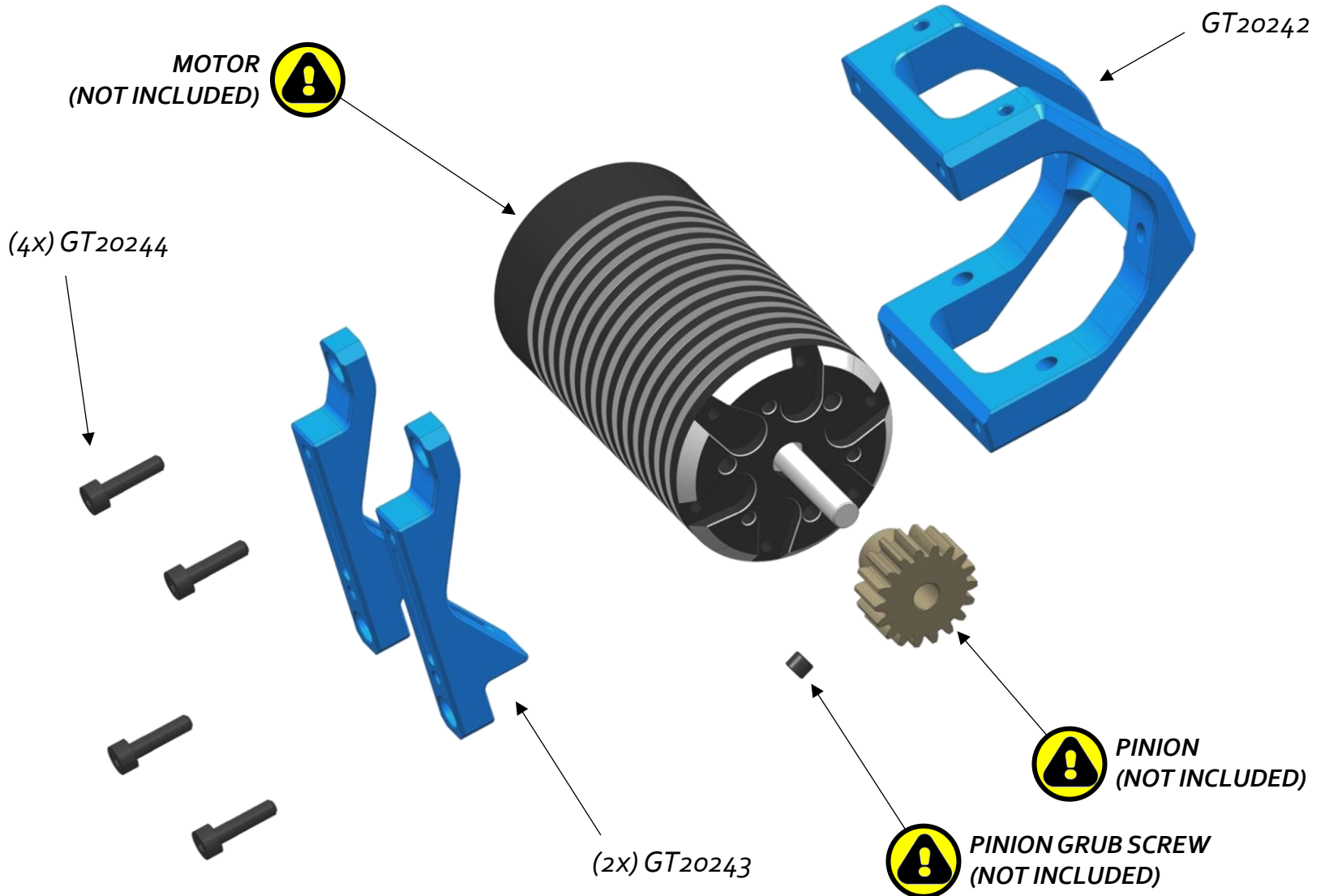

Central Transmission Assembly

Exploded View - Step 0

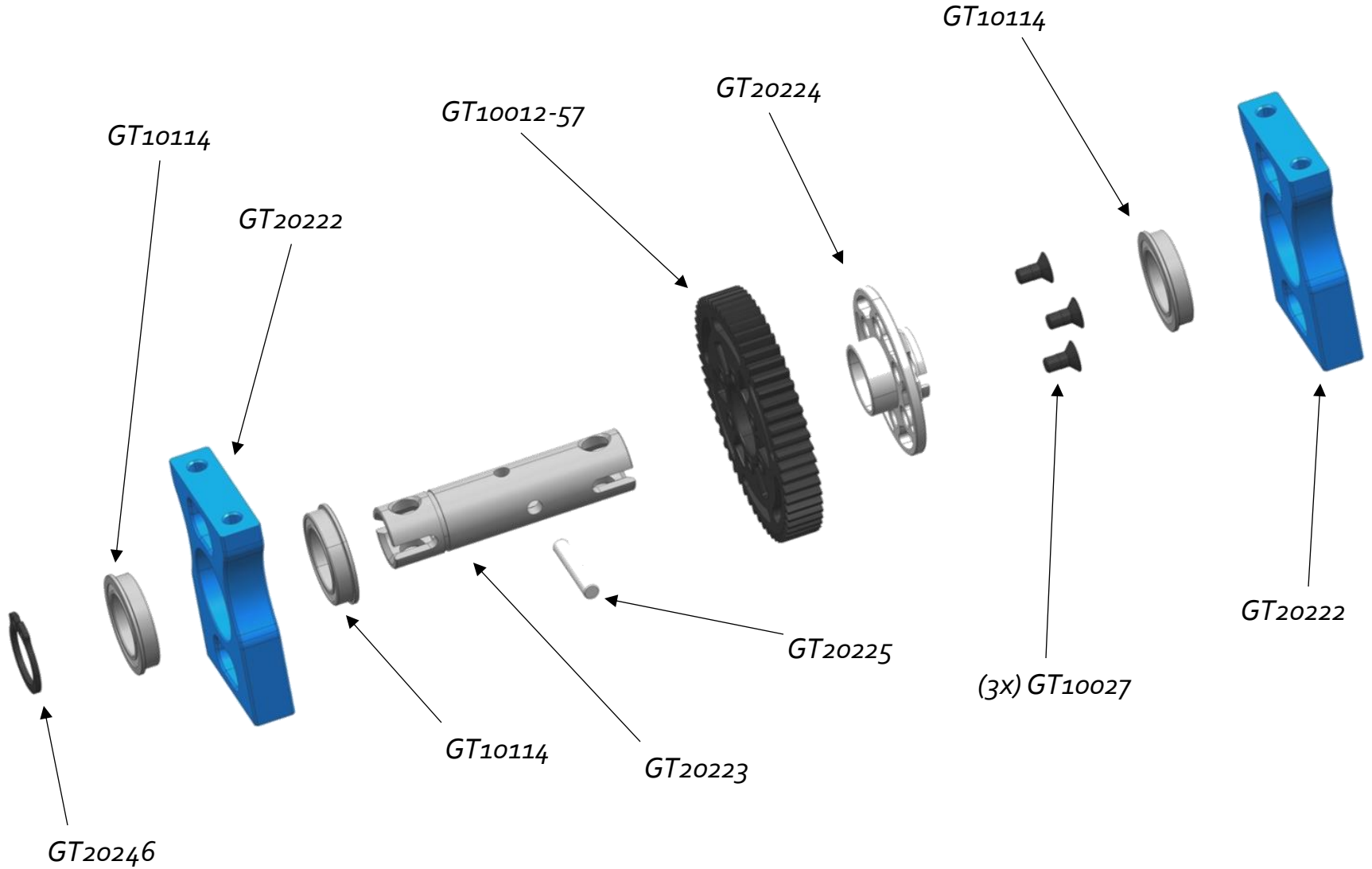

Central Trnasmision Assembly

Exploded View - Step 1

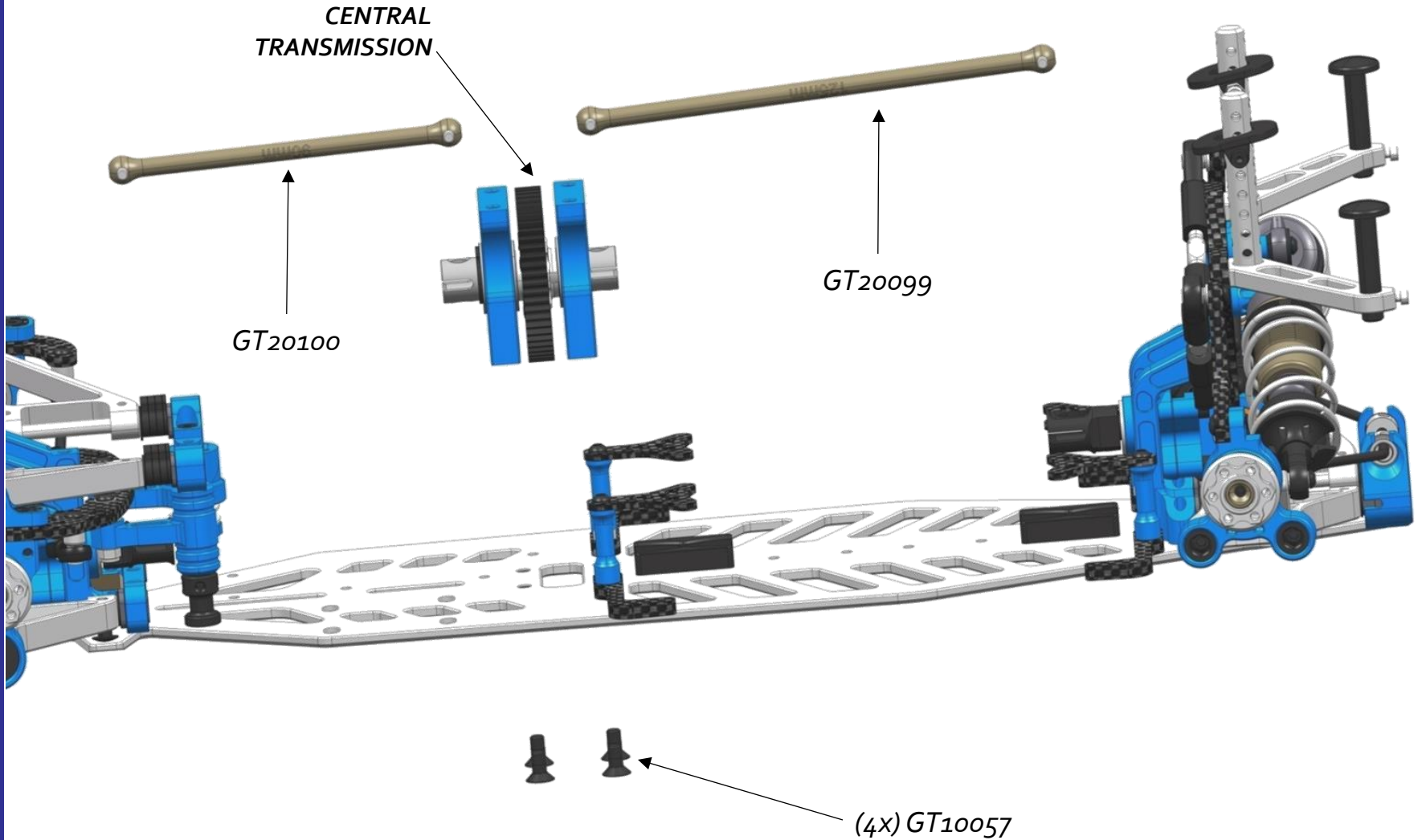

Central Trnasmision Assembly

Exploded View - Step 2

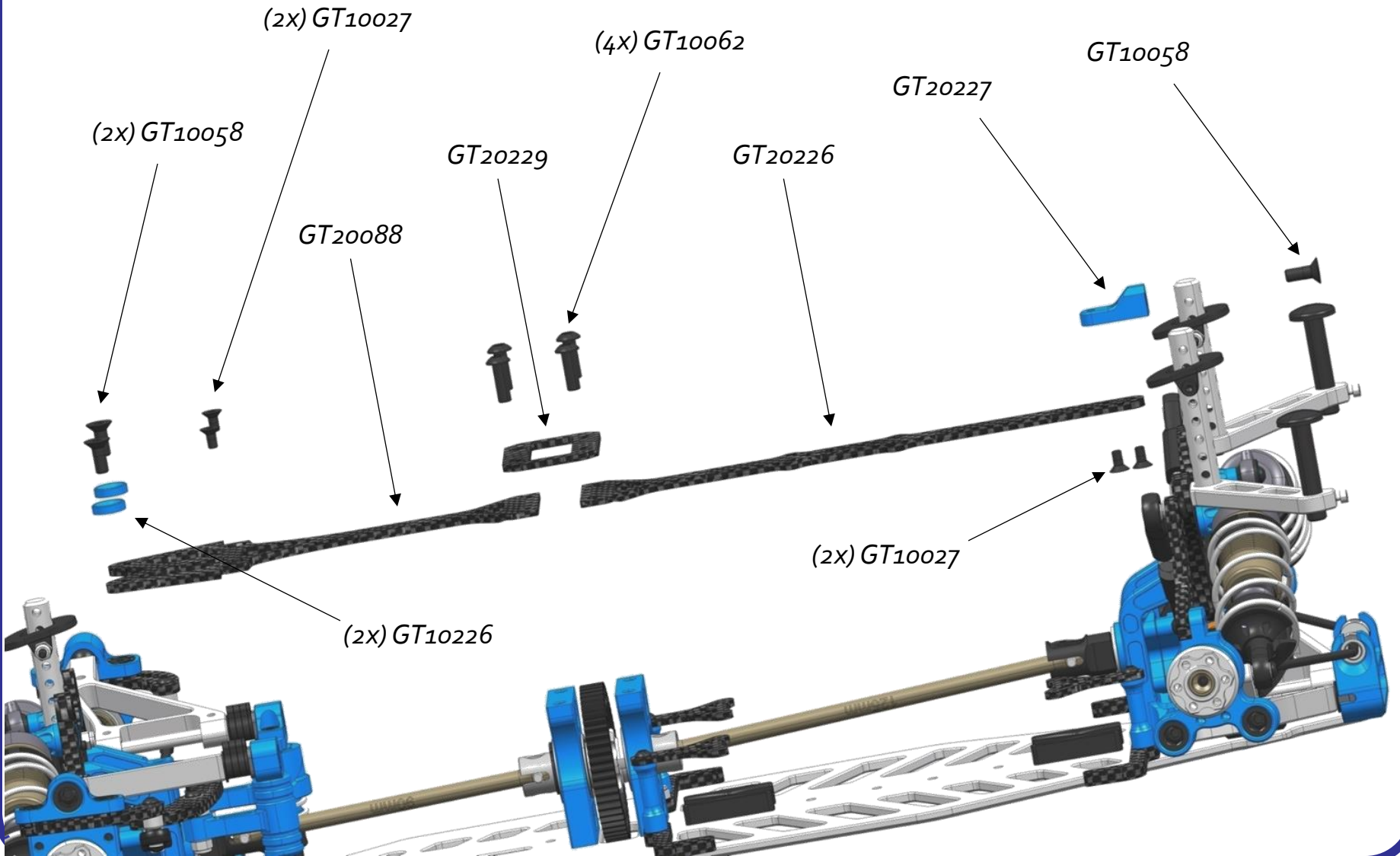

Central Trnasmision Assembly

Exploded View - Step 3



MOTOR

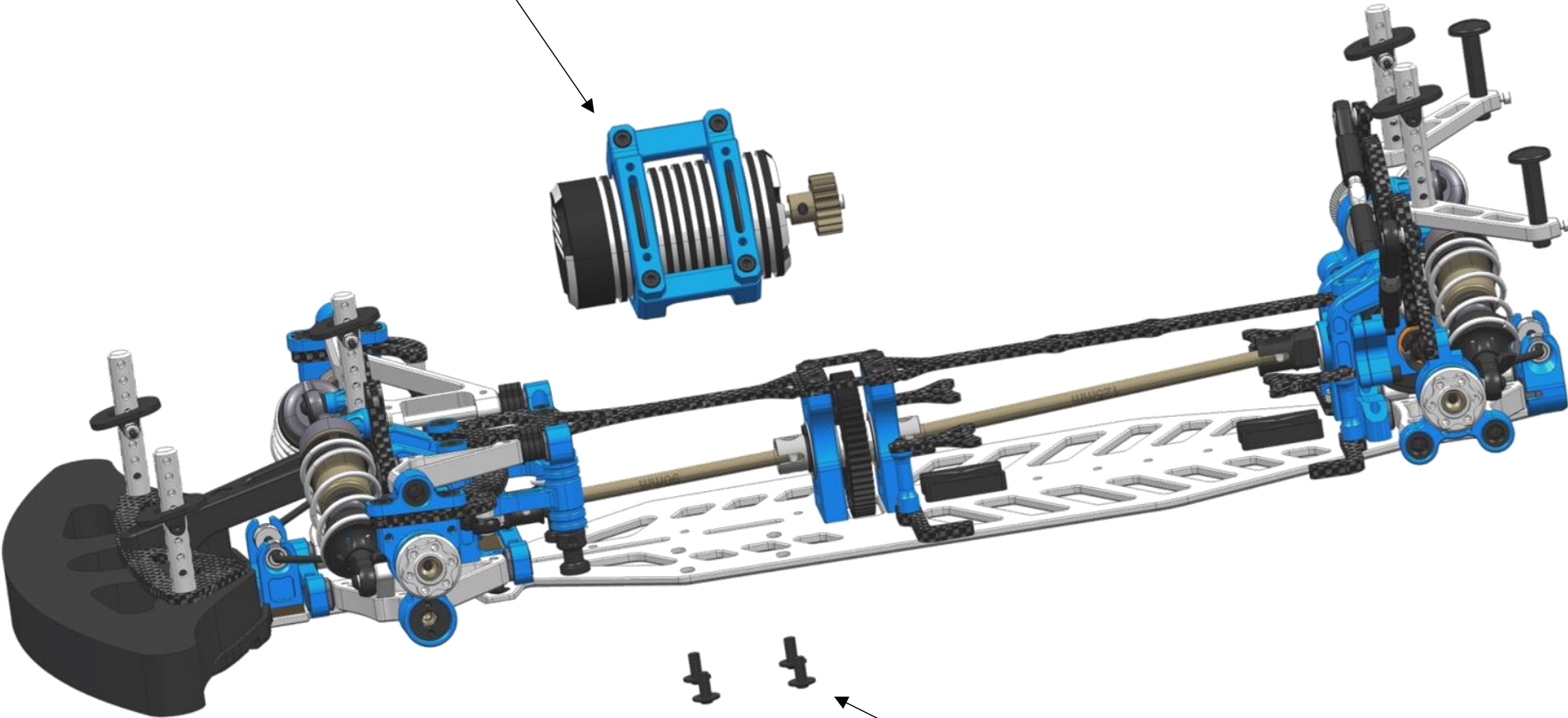
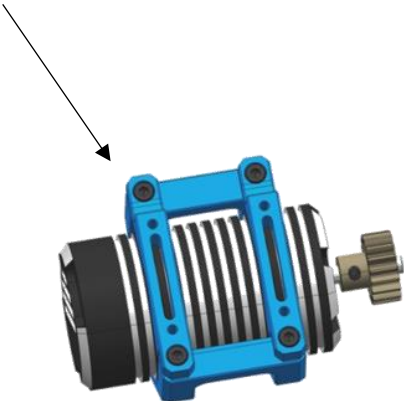

(4x) GT10166

Receiver Box Assembly

Exploded View

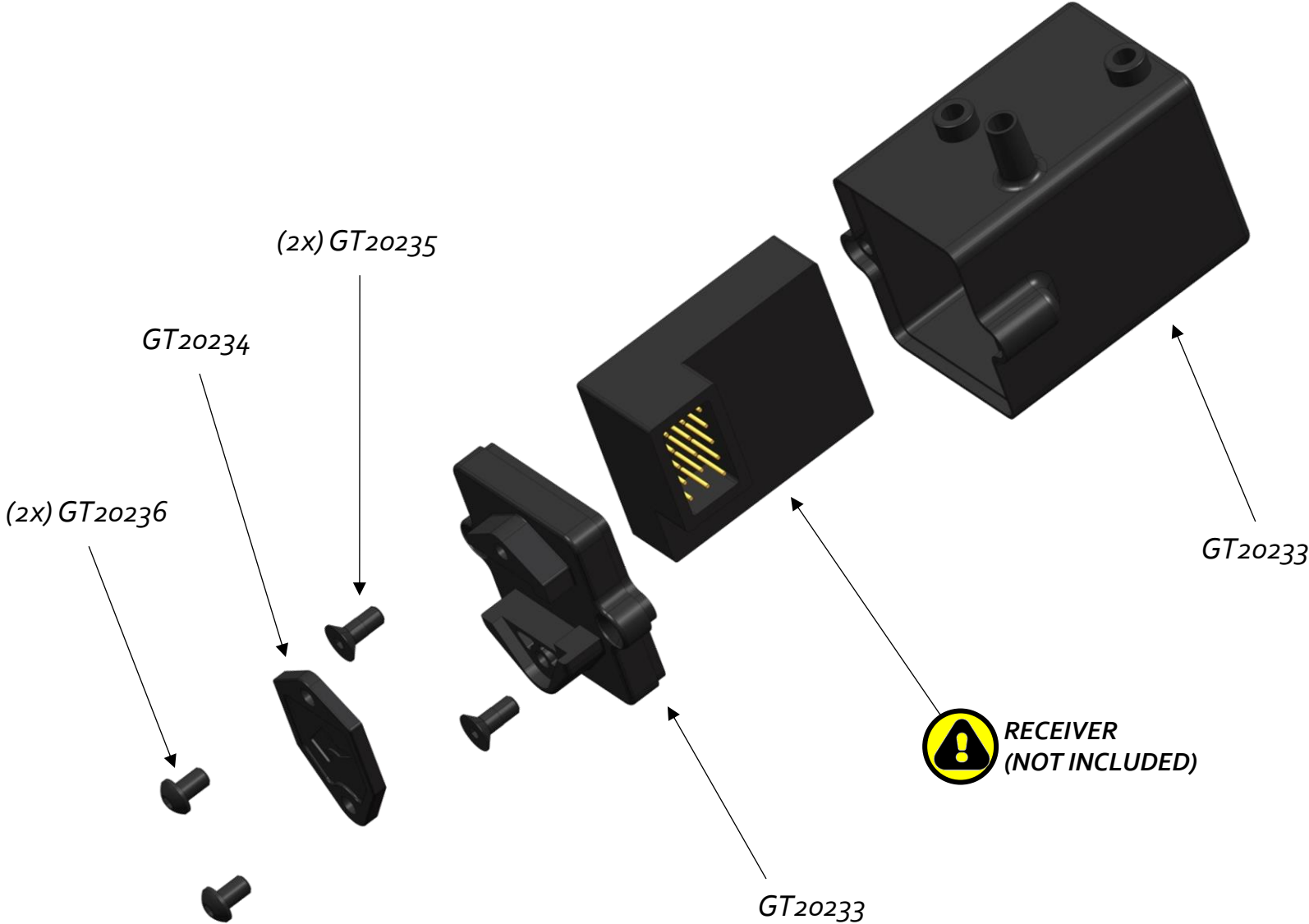

Radioplate Assembly

Exploded View - Step 0

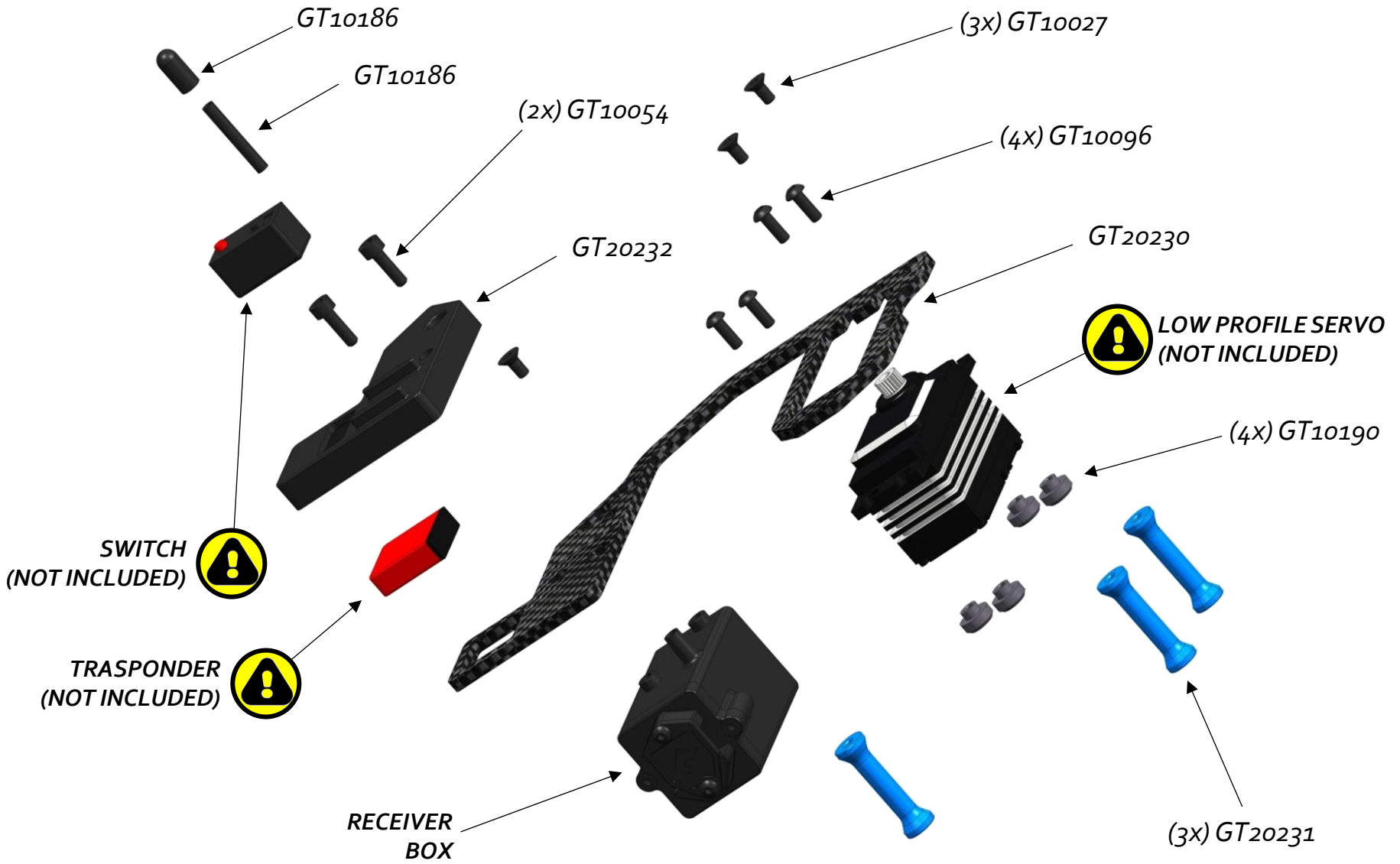

ESC Assembly

Exploded View - Step 1

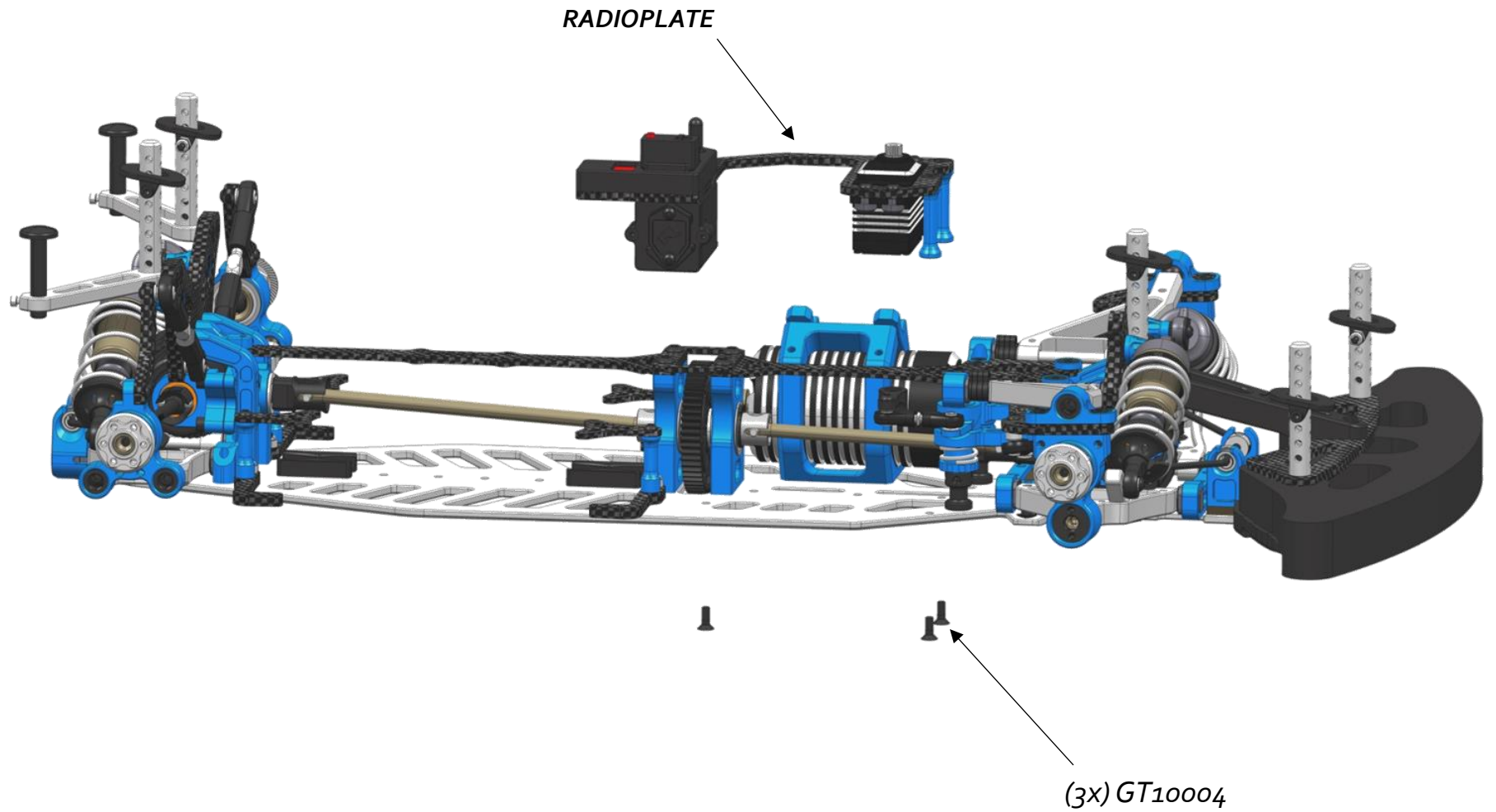

RADIOPLATE

(3x) GT10004

ESC Assembly

Exploded View - Step 0

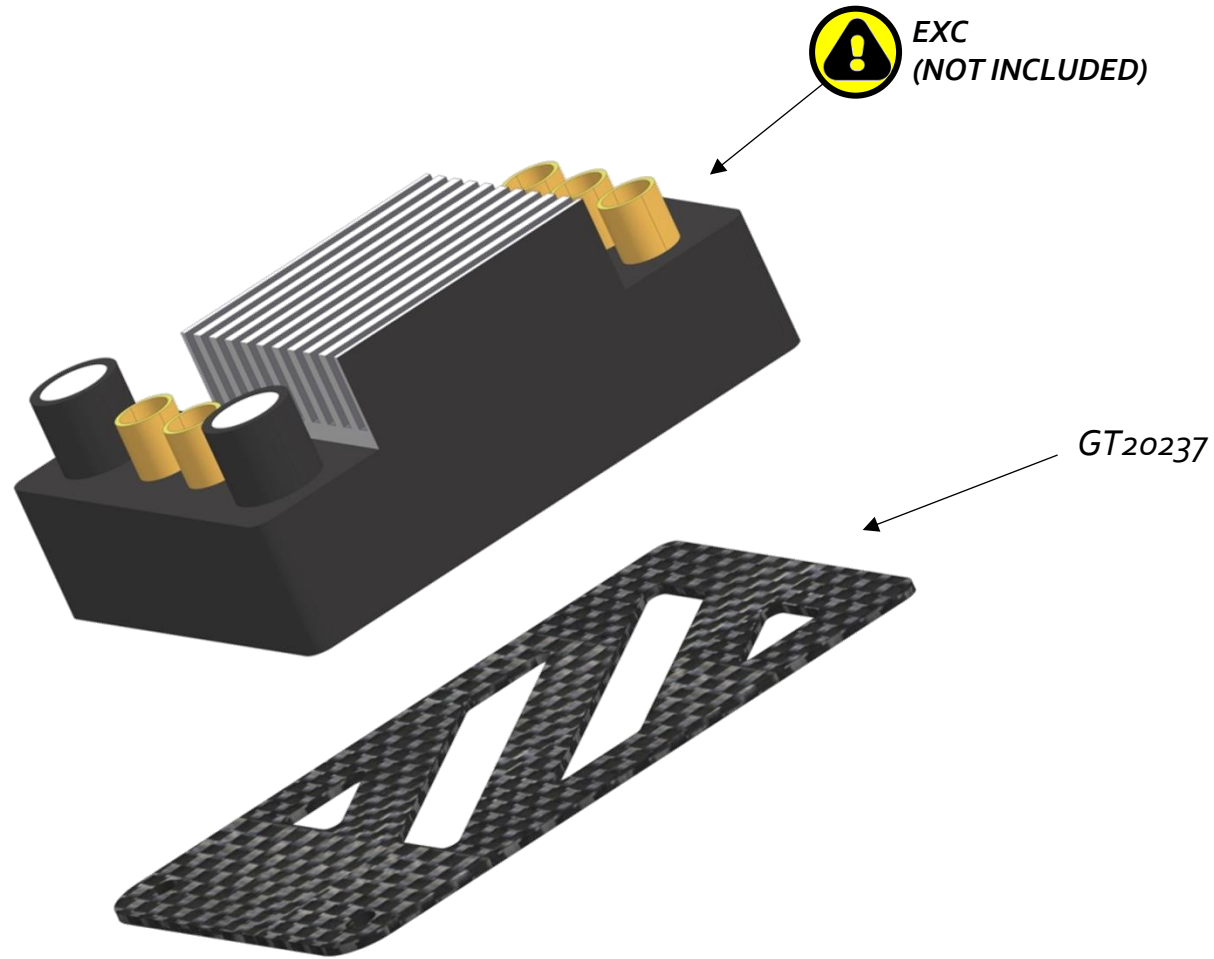

ESC Assembly

Exploded View - Step 1

